

# 10.7 Perimeter

Distance around a polygon

Add all the sides

"fence" "border"

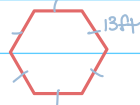
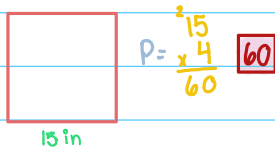

Regular Hexagon

$$P = 3 + 3 + 3 + 3 + 3 + 3$$

$$P = 18 \text{ ft}$$

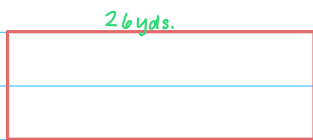

12 yds.

$P = \text{add all sides}$

$$P = 52 + 24 = 76 \text{ yds}$$

$$\begin{array}{r} 26 \quad 12 \\ \times 2 \quad \times 2 \\ \hline 52 \quad 24 \end{array}$$

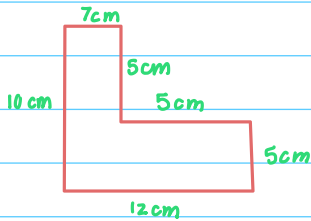

$P = \text{add all sides}$

$$P = 5 + 12 + 10 + 7 + 5 + 5$$

$$P = 44 \text{ cm}$$

10  
10

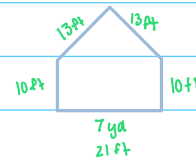

$P = \text{add all sides}$

$$P = 10 + 10 + 13 + 13 + 21$$

$$P = 67 \text{ ft}$$